

EGARA 1 LF 3+0

Power Line SPDs

DIN RAIL - IEC TYPE 1+2



General Data

Internal configuration	3+0
No. Poles	3-Pole
No. DIN rail modules	3
Network configuration	TNC
IEC SPD Type	Class I+II
EN SPD Type	Type 1+2
UL SPD Type	Type 4 Component Assembly
Format	Pluggable
Protection Modes	L-PE(N)
Leakage current free - LCF	Yes
Product standards	IEC/EN 61643-11; UL 1449 5th Edition



PART NUMBERS

XXX	320
EGA 1 XXX /3+0 LF	33738306
EGA 1 XXX /3+0 LF IR (with Remote Indication)	33738307

SURGE PROTECTION DEVICE (SPD) - IEC TECHNICAL FEATURES

EGA 1 XXX /3+0 LF, EGA 1 XXX /3+0 LF IR (with Remote Indication)	320
Maximum continuous operating voltage (AC) - U _c [V]	320
Nominal voltage AC 50-60 Hz - U _n [V]	277/480
Nominal discharge current (8/20)- I _n [kA]	20
Max Discharge Current (8/20) - I _{max} [kA]	50
Lightning impulse current (10/350) - I _{imp} [kA]	12.5
Voltage protection level at I _n - U _p [kV]	≤1,5
Maximum back-up fuse [A [gG]]	315
Short circuit withstand- I _{sc} [kA]	25
Following current - I _{fi} [A]	100
Residual current- I _{pe} [μA]	<10
Response time - t _A [ns]	≤25
Specific energy by pole (10/350 μs) - W/R (L-N) [kJ/ohm]	39
Specific energy by pole (10/350 μs) - W/R (N-PE) [kJ/ohm]	39
TOV 5s (LV systems, withstand) - U _t [V]	403
TOV 120min (LV systems, fail safe)- U _t [V]	528
Dynamic thermal disconnection	Yes
Thermal protection behaviour	OCM (Open Circuit Mode)
No. of ports	1

SURGE PROTECTION DEVICE (SPD) - UL TECHNICAL FEATURES

EGA 1 XXX /3+0 LF, EGA 1 XXX /3+0 LF IR (with Remote Indication)	320
Nominal discharge current (8/20) - I _n [kA]	20
Maximum continuous operating voltage - MCOV (L-L) [V]	640
Maximum continuous operating voltage - MCOV (L-G) [V]	320

DATASHEET

This document is subject to change at any time without notice www.cirprotec.com | Lepanto 49 · 08223 Terrassa, Barcelona Spain © 2024 Cirprotec SLU | All rights reserved

cirprotec

EGARA 1 LF 3+0

Power Line SPDs

DIN RAIL - IEC TYPE 1+2

Continue EGA 1 **XXX**/3+0 LF, EGA 1 **XXX**/3+0 LF IR (with Remote Indication)

EGA 1 XXX /3+0 LF, EGA 1 XXX /3+0 LF IR (with Remote Indication)	320
Measured limiting voltage - MLV (L-L) [V]	2840
Measured limiting voltage - MLV (L-G) [V]	1420

MECHANICAL AND ENVIRONMENTAL FEATURES

EGA 1 XXX /3+0 LF, EGA 1 XXX /3+0 LF IR (with Remote Indication)	320
Temperature range [°C]	-40 ... 85
Humidity range [%]	5 ... 95
Max. Altitude [m]	4000
Indication System Type	Green (OK) / Not green (replace)
Insulating material	PA6 CT1 & PA66 CT1
Housing color	Grey RAL 7035
Enclosure - IP	IP20
Flammability class	UL94 V-0
Solid conductor cross section	1,5...35mm ²
Stranded conductor cross section	1,5...25mm ²
Torque rating [N m]	3
Remote indication conductor cross section [mm ²]	0.5 ... 1.5
Remote indication switching capacity [V/A]	AC: 250/0.5 DC: 30/1

DIMENSIONS AND WEIGHT

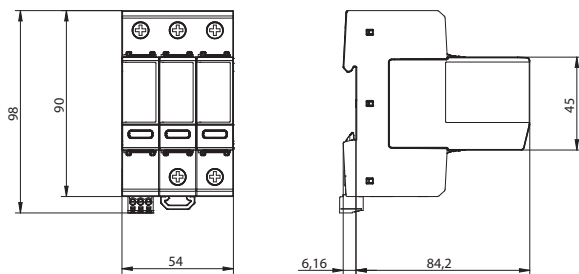

EGA 1 XXX /3+0 LF EGA 1 XXX /3+0 LF IR (with Remote Indication)	320
Net Weight [kg]	0.52
Gross weight [kg]	0.55
Packaging dimensions (H x W x L) [mm]	97 × 59 × 118

INTERNAL CONFIGURATION

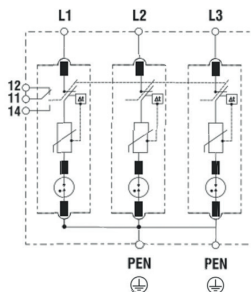

REPLACEMENT CARTRIDGES

EGA 1 XXX /3+0 LF EGA 1 XXX /3+0 LF IR (with Remote Indication)	320
EGARA 1 XXX LF (Line)	33738004

DATASHEET

This document is subject to change at any time without notice www.cirprotec.com | Lepanto 49 · 08223 Terrassa, Barcelona Spain © 2024 Cirprotec SLU | All rights reserved

cirprotec